

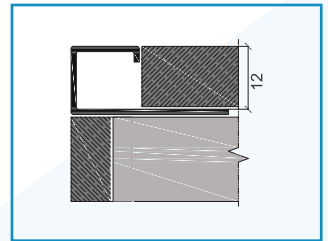

FEATURES

NEXUS NQST is a Square shape Stainless Steel Tile Trim profile for Walls available in both SS304 and SS316L Grades in Polished and Brushed finishes.

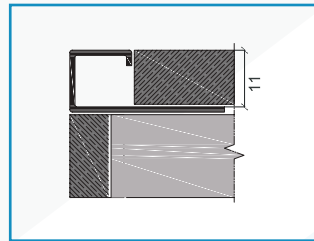
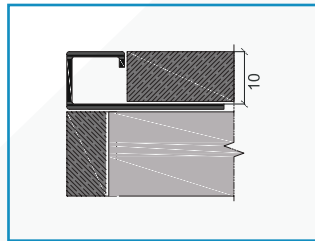
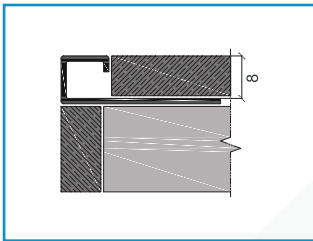

8

SS 304 Polish Finish

Type	H (mm)	L (m)
NQST 08	8	2.7

SS 304 Brush Finish

Type	H (mm)	L (m)
NQSTB 08	8	2.7

SS 316 Polish Finish

Type	H (mm)	L (m)
NQSTL 08	8	2.7

SS 316 Brush Finish

Type	H (mm)	L (m)
NQSTLB 08	8	2.7

10

SS 304 Polish Finish

Type	H (mm)	L (m)
NQST 10	10	2.7

SS 304 Brush Finish

Type	H (mm)	L (m)
NQSTB 10	10	2.7

SS 316 Polish Finish

Type	H (mm)	L (m)
NQSTL 10	10	2.7

SS 316 Brush Finish

Type	H (mm)	L (m)
NQSTLB 10	10	2.7

11

SS 304 Polish Finish

Type	H (mm)	L (m)
NQST 11	11	2.7

SS 304 Brush Finish

Type	H (mm)	L (m)
NQSTB 11	11	2.7

SS 316 Polish Finish

Type	H (mm)	L (m)
NQSTL 11	11	2.7

SS 316 Brush Finish

Type	H (mm)	L (m)
NQSTLB 11	11	2.7

12

SS 304 Polish Finish

Type	H (mm)	L (m)
NQST 12	12	2.7

SS 304 Brush Finish

Type	H (mm)	L (m)
NQSTB 12	12	2.7

SS 316 Polish Finish

Type	H (mm)	L (m)
NQSTL 12	12	2.7

SS 316 Brush Finish

Type	H (mm)	L (m)
NQSTLB 12	12	2.7