

FEATURES

NEXUS NSC 03 profile is a Stainless Steel Channel profile for Floors and Walls in both SS304 and SS316L Grades in Polished and Brush finish.

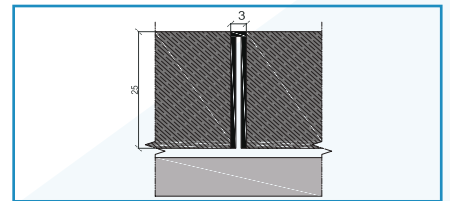
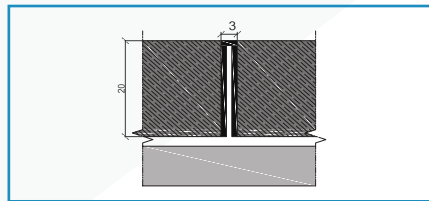
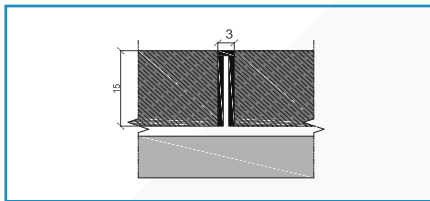
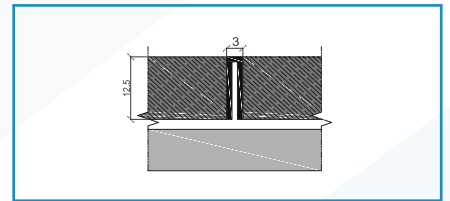
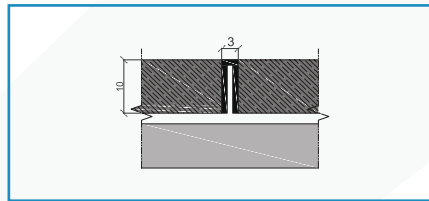
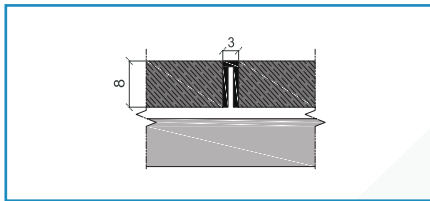

SS 304 Polish Finish

| Type | H (mm) | W (mm) | L (m) |
|----------|--------|--------|-------|
| NSC 0308 | 8 | 3 | 2.7 |
| NSC 0310 | 10 | 3 | 2.7 |
| NSC 0312 | 12 | 3 | 2.7 |
| NSC 0315 | 15 | 3 | 2.7 |
| NSC 0320 | 20 | 3 | 2.7 |
| NSC 0325 | 25 | 3 | 2.7 |

SS 316 Polish Finish

| Type | H (mm) | W (mm) | L (m) |
|-----------|--------|--------|-------|
| NSCL 0308 | 8 | 3 | 2.7 |
| NSCL 0310 | 10 | 3 | 2.7 |
| NSCL 0312 | 12 | 3 | 2.7 |
| NSCL 0315 | 15 | 3 | 2.7 |
| NSCL 0320 | 20 | 3 | 2.7 |
| NSCL 0325 | 25 | 3 | 2.7 |

SS 304 Brush Finish

| Type | H (mm) | W (mm) | L (m) |
|-----------|--------|--------|-------|
| NSCB 0308 | 8 | 3 | 2.7 |
| NSCB 0310 | 10 | 3 | 2.7 |
| NSCB 0312 | 12 | 3 | 2.7 |
| NSCB 0315 | 15 | 3 | 2.7 |
| NSCB 0320 | 20 | 3 | 2.7 |
| NSCB 0325 | 25 | 3 | 2.7 |

SS 316 Brush Finish

| Type | H (mm) | W (mm) | L (m) |
|------------|--------|--------|-------|
| NSCLB 0308 | 8 | 3 | 2.7 |
| NSCLB 0310 | 10 | 3 | 2.7 |
| NSCLB 0312 | 12 | 3 | 2.7 |
| NSCLB 0315 | 15 | 3 | 2.7 |
| NSCLB 0320 | 20 | 3 | 2.7 |
| NSCLB 0325 | 25 | 3 | 2.7 |